

Fireguard Door Leaf

FIRE RATED DOORS



Strong and safe, these doors are fire rated to AS1530.4 1995 and BS476 PT22, 1987.

ARA Manufacture's Fireguard doors are 42mm metal clad and insulated with a rigid core.



OVERVIEW

A 45mm metal clad, insulated, rigid core, fire rated door to AS1530.4 1995 and BS476 PT22, 1987.

STANDARD SPECIFICATIONS

- 45mm (nominal) door leaf clad both sides with 0.8mm galvanised steel skins, internally edge cleat joined at edges to provide hidden edge fixing.
- External steel skins are bonded to a proprietary panel, with internal steel cap reinforcing to closer, lock and hinge positions.
- Lock hardware latch plate is recessed into the door edge so as to be flush (or near flush) with the external edge surface of the door leaf.
- Door leaf to be finished as specified.

Specifications are subject to change without notice.

FIRE RATING

Fire rated up to 120 minutes

FIRE RATED DOORS

Fireguard Door Leaf

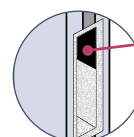
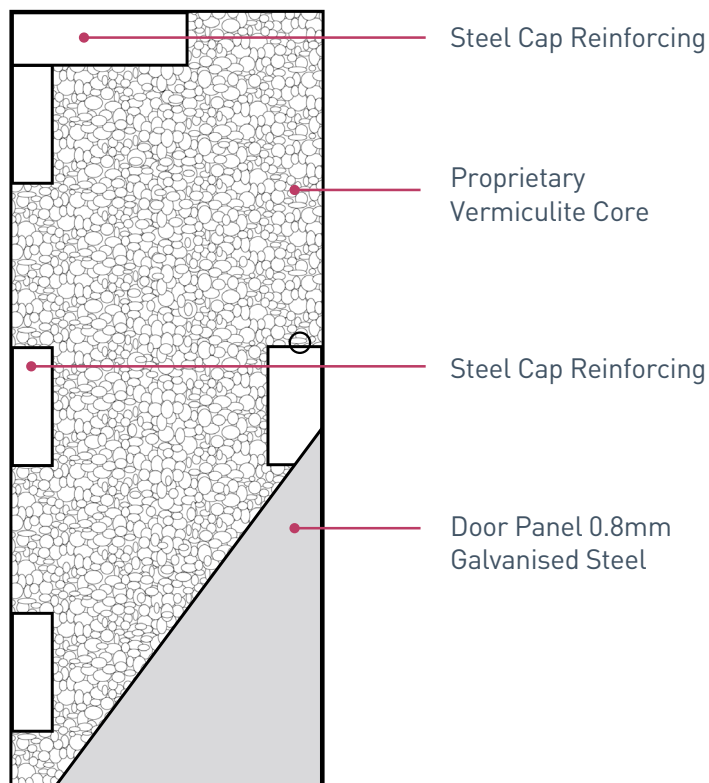

Mortise Lock Preparation
 Recess in steel surface allows face plate of mortise lock to flush fix

LEAF DIMENSIONS & OPTIONS	
WEIGHT	SKIN THICKNESS
69kg for standard 2040 x 818 x 45mm leaf	Standard 0.8mm Options: up to 1.2mm
SKIN MATERIAL	FINISH
Standard: Galvenised Steel Options: Stainless Steel 0.9mm	Standard: bare metal or polyester powdercoated Options: primed or wet sprayed
HEIGHT STANDARD	WIDTH NOMINAL
2040mm 2040mm 2040mm	718mm 818mm 918mm
THICKNESS NOMINAL	SPECIAL SIZES UP TO:
45mm 45mm 45mm	2400mm 1450mm